



# Grime Pro

## User Guide



Vax Careline: (UK) 0844 412 8455  
(ROI) 1-800 928 308

# Machine Overview

- 1 Water tank
- 2 Steam nozzle
- 3 Detergent/ Solution control dial
- 4 Safety pressure indicator
- 5 Water tank lid
- 6 Steam trigger
- 7 Carry handle
- 8 Detergent tank
- 9 Power button
- 10 Power indicator light  
(water heating)  
(blue LED)
- 11 Steam ready indicator light  
(green LED)
- 12 Measuring jug
- 13 Window/upholstery tool
- 14 Upholstery tool cloth
- 15 Concentration nozzle
- 16 Small plastic brush
- 17 Large plastic brush
- 18 Scraper tool
- 19 Bending nozzle
- 20 Gap brush with bristles/ Grout brush
- 21 Accessory Adapter
- 22 Hose
- 23 1 x 4 Finger fork
- 24 1 x 4 Finger fork cloth
- 25 1 x 2 Finger fork
- 26 1 x 2 Finger fork cloth
- 27 Vax Steam detergent
- 28 Accessory bag

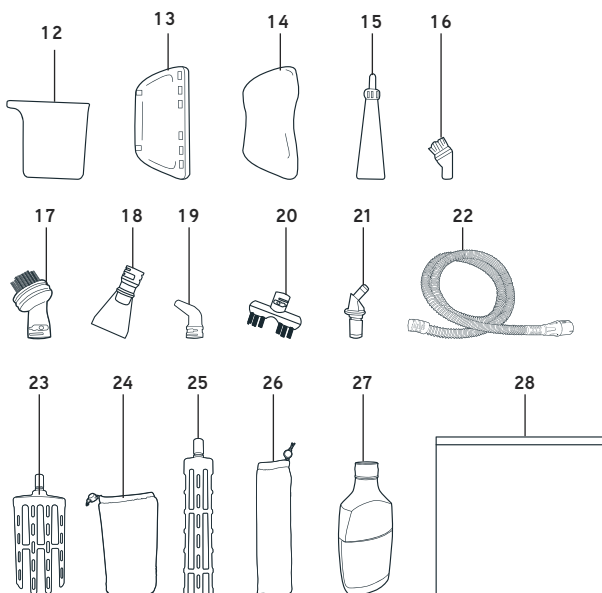

# General Safety Information

## FOR HOUSEHOLD USE ONLY.

When using the steam cleaner, basic safety precautions should always be observed, including the following:

**IMPORTANT:** Please refer to the upholstery/surface manufacturer's care recommendations before use and test the steamer on a discrete surface to begin with.



**WARNING:** The steam cleaner unit and accessories get very hot during operation.

**DANGER OF SCALDING:** Avoid contact with the steam.

1. Do not leave the steam cleaner unattended when plugged in. Unplug it from socket when not in use.
2. To prevent electric shock do not use outdoors.
3. Not to be used as a toy. Close supervision is necessary when used near children or the infirm.
4. Use only as described in this manual.
5. Do not use the steam cleaner if it has been dropped, damaged, left outdoors or dropped into water. Do not use the steam cleaner with a damaged cord or plug. If the supply cord is damaged, call the Vax customer careline on 0844 412 8544
6. Do not pull or carry by the cord, use the cord as a handle, allow the cord to come into contact with hot or sharp surfaces or close a door on the cord.
7. Do not unplug by pulling on the cord.
8. Do not handle the plug or steam cleaner with wet hands.
9. Do not put any objects into openings or operate with openings blocked.
10. Do not use without the tank cap in place.
12. Do not use an extension cord.
13. Do not attempt to remove blockages with sharp objects as they may cause damage.
14. Store indoors, put away after use to prevent tripping accidents.
15. Using improper voltage may result in damage to the steam cleaner and possible injury to the user. The correct voltage is listed on the rating label.
16. A hazard may occur if the steam cleaner runs over the power supply cord.
17. The steam cleaner must be kept level during operation.
18. Never immerse the steam cleaner in water or other liquids.
19. Keep the steam cleaner away from rain and moisture. The steam cleaner is not suitable for outdoor use.
20. Do not operate the steam cleaner without water in the tank. Always top up with water in good time.
21. Empty the water tank when the steamer is not in use.
22. Never fill the tank with anything other than water. Never put additives (such as perfume, stain remover or products

containing alcohol) in the water as they may damage the steam cleaner or make it dangerous to use.

23. Always remove the mains plug from the socket and allow this steam cleaner to cool down completely before topping up with water.
24. Do not overfill the tank. Do not exceed the maximum prescribed filling level. Please use the measuring jug included.
25. Ensure that the water tank cap has been screwed down fully before use.
26. Only carry the steam cleaner by the carry handle.
27. Do not touch any hot areas on the steam cleaner. It is normal for the steam cleaner to heat up during operation.
28. Do not use the steam cleaner to treat any items of clothing that are still being worn on the body.
29. The force and heat of the steam may have an adverse effect on some materials. Always check whether a surface is suitable for treatment with the steam cleaner by carrying out a test beforehand on a concealed area.
31. Always include these operating instructions if passing the steam cleaner on to a third party.
32. Never aim the steam cleaner at people, animals or plants (risk of scalding)! Do not aim the steam cleaner at electrical systems or wires.
33. Please always switch the appliance off and remove the mains plug from the socket if leaving the work area.
34. The steam cleaner is fitted with a thermostat and a thermal cut-out as protection against overheating.
35. Accessories become hot during use - allow them to cool down before handling.
36. Please ensure all parts are correctly fitted before using the product.
39. Do not use your steam cleaner if damaged/faulty. Please call our Vax Careline on 0844 412 8455.
40. Do not use unit on leather, wax polished furniture or floors, synthetic fabrics, velvet or other delicate steam or water sensitive materials.

**NOTE:** The liquid or steam must not be directed towards equipment containing electrical components.

**This steamer is for household use only and NOT for commercial or industrial use.**

**PLEASE KEEP INSTRUCTIONS FOR FURTHER USE.**

# Getting Started

## Operating your steam cleaner

**NOTE:** Whilst in use do not recline unit more than 45 degrees.

**CAUTION:** Do not use hot or boiling water to fill water compartment. Do not open the water tank lid when using the steamer. Your steamer is pressurised, do not completely remove the lid when tank is hot. Fill tank only when cool. Do not overfill the water or detergent tank compartments.

**IMPORTANT:** After use, switch off the machine, compress the trigger to release all remaining steam. Allow machine to cool for a minimum of 10 minutes before refilling or storing.

## Filling the water tank

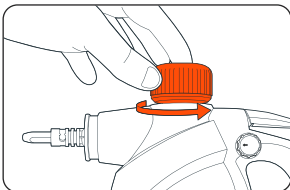

Place steamer on a level surface and ensure steamer is switched off and is cool. To remove lid push down and twist anti clockwise.

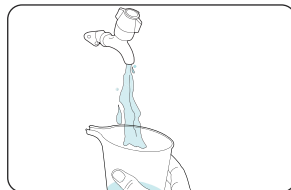
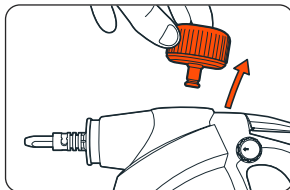

Fill measuring jug with maximum 300ml.

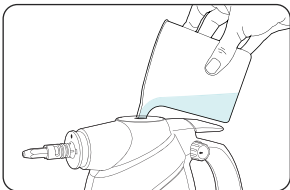

Slowly pour water into water tank. Do not overfill the water tank. Allow space to be left at the top.

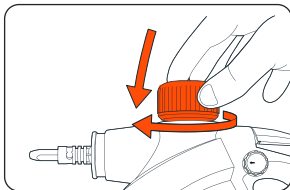

Ensure the lid is securely fastened by turning in a clockwise direction.

## Filling the detergent tank

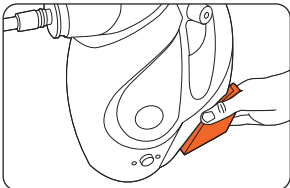

Squeeze tabs on side of detergent tank to slide tank out of steamer.

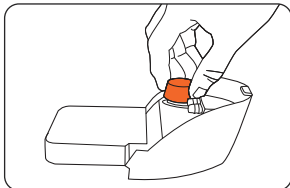

Remove cap from detergent tank and fill with maximum 120ml of Vax detergent. Replace cap firmly and slide solution tank back into steamer  
**NOTE:** For best results, fill with 120ml of detergent. Alternatively dilute the mixture with 50ml detergent and 70ml water

# How To Use

## Operating your steamer

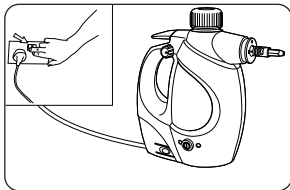

Plug in steamer and switch on at the mains.

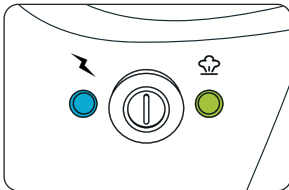

After you plug in and switch on your machine you will see a blue LED which indicates water is being heated. After 5 minutes a green LED will indicate that your steamer is ready to use.

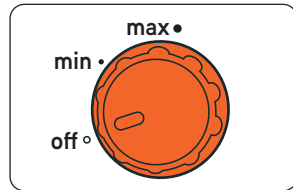

If you wish to clean with steam alone, simply turn the Detergent Control Dial to OFF.

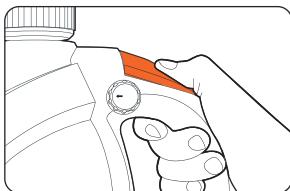

Depress the trigger to release steam/steam+detergent from the nozzle.

If you wish to clean using Vax Solution, simply turn the Detergent Control Dial to the desired setting. Now, when pressing the Steam Trigger, the steam cleaner will release the amount of solution that is indicated on the Detergent Control Dial as well as steam.

# How To Use

## Accessories

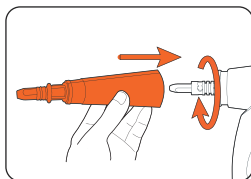

### Attaching small tools

Small tools can be attached via connector when required. Twist to connect.

### Attaching larger tools

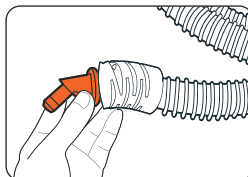
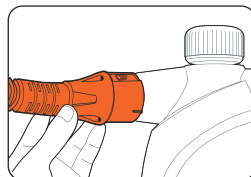
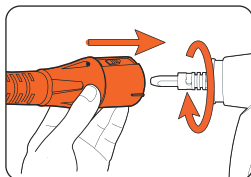

Attach accessory adapter to the hose so that small tools can be used with the hose.

Larger accessories can be attached using the hose. The hose should be rotated clockwise until locked into position and secure. To remove hose, turn anti-clockwise.

### Using the tools

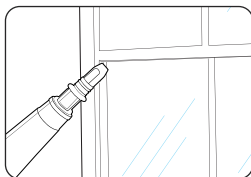

#### Concentration nozzle

Use to remove soap scum in baths and shower enclosures and to clean heavily soiled areas in kitchens.

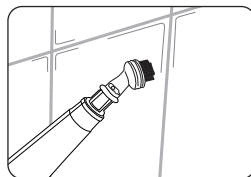

#### Brush

Ideal for any surface from tiles, sinks, toilets and oven tops.



#### Squeegee tool

Great for leaving your windows, tiles and mirrors gleaming.

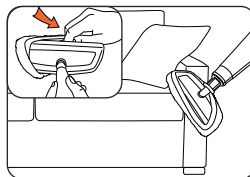

#### Upholstery/clothes tool

Attach the cloth to the squeegee tool for use on upholstery and cloths.

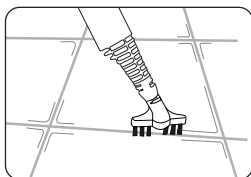

#### Grout brush

Lifts embedded dirt from inbetween tiles.



#### Bending nozzle

For hard to reach areas e.g. around taps.

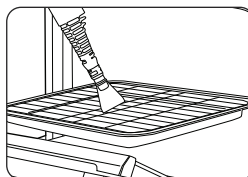

#### Scraper tool

Ideal for removing dried on residue from in ovens, work surfaces and pans.

**IMPORTANT:** Test for colour fastness in a small hidden area of upholstery/fabric to check for colour removal before use.

**IMPORTANT:** Taps should be turned off when steaming around them. Do not steam clean ovens, oven surfaces or grills when hot. Allow to cool to room temperature

# Looking After Your Machine

## Refilling and Storing

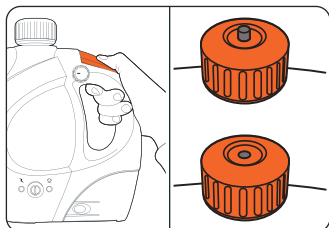

After using your steamer, press the Power Button to turn power "OFF" and then unplug the power cord from the mains. Release excess pressure by depressing the trigger and releasing steam before opening the water cap. This can be ensured when the pressure indicator is completely depressed in the cap.

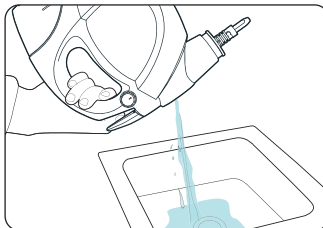

After allowing steamer to cool for a minimum of 10 minutes, slowly start to unscrew the lid anti-clockwise while gently pushing on the trigger. **DO NOT FULLY UNSCREW THE WATER FILL SAFETY CAP.** Allow steam cleaner to cool an additional 5 minutes. After you have ensured the steam cleaner has cooled and pressure has been released, the lid should turn freely for removal. Unscrew the lid completely. Empty the residual water in the tank and allow to dry. Clean the external surface with a dry cloth.

## Cleaning cloths

**IMPORTANT:** Never use bleach or fabric softener when washing the cloths.

- 1 Wash by hand or machine washable at 'warm' temperature. Always use a mild detergent.
- 2 Allow cloths to completely dry before next use.

## Cleaning your steamer

**IMPORTANT:** Always ensure before cleaning or maintaining the steam cleaner that it is switched off, unplugged from the mains and cooled down to room temperature. Only clean the steam cleaner by wiping over the housing with a slightly moistened cloth. Do not use any cleaning agents, abrasives or alcohol since they may damage the housing. Vax recommend that the tank be rinsed out after 5 filling operations at the latest if water hardness is above 1.8 mmol/l (100d/H). Information regarding local water hardness may be obtained from the water or utility company. Vax recommend filling the water tank with water and giving it a good shake to clean it. This will loosen any limescale that has been deposited on the bottom of the steam cleaner. Pour out the water and allow the tank to dry out completely before closing it. The water tank should be treated with limescale remover approx. every 6 months to prolong the steam cleaner's life. Place one (or at most two) limescale removal sticks in 0.3 litre of warm water (50°C) and fill the water tank with it. Allow the solution to work for approx. 30 minutes then pour away the water with the dissolved solids. Repeat this process if necessary then rinse out the tank with water.

# FAQs

**WARNING:** to reduce the risk of personal injury, unplug the steamer and ensure unit has fully cooled down before performing maintenance/troubleshooting checks.

## Is there an accessory missing?

- Check the parts overview page in this guide to make sure the part is definitely included with your machine.
- If the part is missing, we're here to help. Simply call us on: **0844 412 8455**

## What do I do if the machine/an accessory has become damaged or broken?

- Visit **vax.co.uk** for spares and parts.
- Please call our Careline to purchase new spares or order a replacement.

## What to do if the steam cleaner has no power?

- The unit may not be plugged into an electrical outlet; ensure the plug is pushed in securely.
- Check the mains power is switched on.
- The electrical outlet may not be working; check the fuse or breaker and consult an electrician.
- The power cord may be damaged; if it is it must be replaced by the manufacturer.

## Why is the steam cleaner not producing steam?

- Check the mains power is switched on.
- There may be no water in the tank; please refer to the operation section.
- Check that the safety latch has been unlocked on the steam handle.
- Check that the unit has not been overfilled as there must be space in the tank for the water to heat. If overfilled the unit will deliver little steam or water droplets.
- The water may not yet be at temperature; the green and red steam ready indicator light will both be illuminated

when the water is at temperature and is ready to use.

- If the unit is producing a very small amount of steam, check the variable steam power dial and adjust to max.
- If none of the points above are of assistance, we're here to help. Simply call us on: **0844 412 8455**
- When the unit has been switched off and fully cooled remove the water tank lid. If limescale build up can be seen inside the tank the unit will need to be descaled.

## What do I do if the steam cleaner takes a long time to heat up?

- When the unit has been switched off and fully cooled remove the water tank lid. If limescale build up can be seen inside the tank the unit will need to be descaled.
- Otherwise, we're here to help. Simply call us on: **0844 412 8455**

## we're here if you need us

Instead of taking me back to the shop, simply visit:

**vax.co.uk/support**  
**vaxireland.ie**

or call:

(UK) 0844 412 8455  
(ROI) 1-800 928 308

This does not affect your statutory rights



# Other Information

## UK Service & Help

Vax Careline:

(UK) 0844 412 8455

(ROI) 1-800 928 308

Monday-Friday        8.30am to 6.30pm

Saturday                9.00am to 5.00pm

Any queries or concerns about using your Vax, call the Vax Careline. Calls are charged at the UK local rate. Please make a note of the serial number and model number of the steam cleaner before calling. For the nearest Service Agent, please call the Vax Careline or visit **vax.co.uk**

## Consumables

Upholstery cloths (Type 5):	1-1-130746-00
Microfibre narrow pads (2 Finger fork cloth) (Type 7):	1-1-133081-00
Microfibre wide space pads (2 Finger fork cloth) (Type 8):	1-1-133082-00
Steam cleaning kit (Type 1):	1-1-132732-00
Steam brush kit (Type 3):	1-1-132730-00

## Technical Specification

Wattage:	1200W
Voltage:	220 - 240V - 50Hz
Water tank capacity:	300ml
Detergent tank capacity:	120ml
Weight:	2.5kg
Cord length:	5m

Subject to technical change without notice.

# Other Information



## EEC Statement of Compliance

Manufacturer/EEC importer: Vax Limited, hereby on our own responsibility, declare that the S4 series is manufactured in compliance with the following Directives:

**Safety:** 2006/95/EC Low Voltage Directive

**EMC:** 2004/108/EC Electromagnetic Compatibility Directive



Waste electrical products should not be disposed of with household waste. Please recycle where facilities exist. Check with your Local Authority or retailer for recycling advice.





Vax Ltd., Kingswood Road, Hampton Lovett, Droitwich, Worcestershire, WR9 0QH, UK email:  
[info@vax.co.uk](mailto:info@vax.co.uk) website: [vax.co.uk](http://vax.co.uk)