



# Utility Master

## Steam cleaner

### User Guide

S10 Series



# Contents

Contents	1
Machine Overview	2
General Safety Information	3
Getting Started	4
How To Use	5
Looking After Your Machine	7
FAQs	8
Other Information	9
Guarantee	10

# Machine Overview

- 1 Accessory storage cover
- 2 Water lid
- 3 Carry handle
- 4 On/off button
- 5 Power light
- 6 Steam ready light
- 7 Steam adjustment dial
- 8 Hose connector and cover
- 9 Steam gun and hose
- 10 Detailer tool
- 11 Small plastic brush
- 12 Large plastic brush
- 13 Scraper tool
- 14 Concentration nozzle
- 15 Window tool
- 16 Floor brush
- 17 3pc extension tube
- 18 Funnel
- 19 Measuring jug
- 20 Microfibre pad
- 21 Upholstery tool cloth
- 22 Floor head connector
- 23 Cord holder

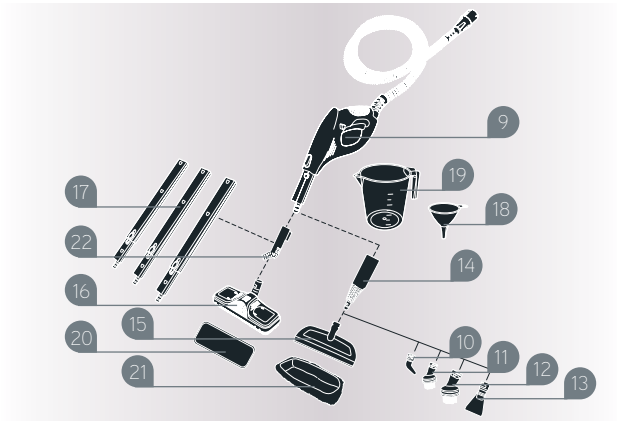

# General Safety Information

**This steam cleaner is intended for household use only and NOT for commercial or industrial use.**

Please keep instructions for further use.

When using the steamer, basic safety precautions should always be observed, including the following:

**Warning:** The steam cleaner unit and accessories get very hot during operation.



**DANGER OF SCALDING:** Avoid contact with the steam.

- Do not leave the steam cleaner unattended when plugged in. Unplug the product from the socket when not in use.
- Only use the steam cleaner indoors. Keep the steam cleaner away from rain and moisture.
- Turn off the on/off switch on the steamer controls before disconnecting or connecting from the mains supply.
- Always unplug the steam cleaner and allow it to cool before connecting or disconnecting the hose or accessories.
- Children should be supervised to ensure that they do not play with the appliance.
- This appliance is not intended for use by children under eight years of age and persons with reduced physical, sensory or mental capabilities or lack of experience and knowledge, unless they have been given supervision or instruction concerning use of the appliance in a safe way and understands the hazards involved.
- Cleaning and maintenance shall not be made by children without supervision.
- The appliance should only be used as described in the quick start guide or in the full online user guide.
- Only Vax recommended attachments should be used with this appliance.
- Do not use this steam cleaner if it has been dropped, damaged, left outdoors or dropped into water. Do not use this steamer with a damaged cord or plug. If the supply cord is damaged call the Vax Customer Careline.
- Do not pull or carry this appliance by the cord. Do not use the cord as a handle, close a door on the cord or pull the cord around sharp edges or corners. Do not run the steamer over the cord. Keep the cord away from heated surfaces.
- Do not unplug the product by pulling on the cord.
- Do not handle the plug or the steamer with wet hands.
- Do not use without the tank cap in place. Ensure that the water tank cap has been screwed down fully before use.
- Do not touch any hot areas on the steam cleaner. It is normal for the steamer to heat up during operation.
- Accessories will become hot during use – allow them to cool down before handling.
- Do not use the steam cleaner to treat any items of clothing that are still being worn on the body.
- The force and heat of the steam may have an adverse effect on some materials. Always check whether a surface is suitable for treatment with the steam by carrying out a test before hand on a concealed area.
- The steam cleaner must be kept level during operation.
- Never immerse the steam cleaner in water or in other liquids.
- Do not operate the steam cleaner without water in the tank. Always top up with water in good time.
- Always remove the mains plug from the socket and allow the steam cleaner to cool down completely before topping up with water.
- Never aim the steam cleaner at people, animals or plants (there is a risk of scalding). Never touch the steam jet from a short distance with your hands. Do not aim the steam cleaner at electrical items or wires.
- Keep hair, loose clothing, fingers and all parts of the body away from openings.
- Never fill the water tank with anything other than water. Never put additives (such as perfume, stain remover or products containing alcohol) in the water as they may damage the steam cleaner or make it dangerous to use.
- Only carry the steamer by the carry handle.
- Store the steam cleaner in a cool, dry area.
- Do not use an extension cord with this product.
- Using improper voltage may result in damage to the steam cleaner and possible injury to the user. The correct voltage is listed on the rating label.
- Do not use your steam cleaner if it is damaged or faulty. Please make sure that the product is unplugged from the mains and call the Vax Careline on 0844 412 8455.
- Do not use the unit on leather, wax polished furniture or floors, synthetic fabrics, velvet or other delicate steam or water sensitive materials.
- Do not use on acrylic surfaces.
- In wet rooms, e.g. bathrooms, connect the appliance to sockets with an RCD adaptor connected in series.
- The device should not be used to clean electrical appliances such as, microwaves, televisions and electrical heating systems etc.
- Be very careful when cleaning tiled walls with sockets.
- Keep the unit on the floor.
- Empty the water tank when the steamer is not in use.
- Do not overfill the tank. Do not exceed the maximum prescribed filling level. Please use the measuring jug and funnel included.
- Always show these instructions to a third party if you are passing the steam cleaner on to them.
- Please ensure all parts are correctly fitted before using the product.
- Do not attempt to remove blockages with sharp objects as they may cause damage.
- Take extra care when cleaning on the stairs.
- Keep cleaning area well lit.

**Warning:** Always switch off and unplug the steam cleaner from the electrical outlet before assembling, opening or emptying the water tank, or before connecting/disconnecting the attachments.

**Important:** The liquid or steam must not be directed towards equipment containing electrical components, such as the interior of ovens.

**Important:** The steamer is equipped with a thermostat and a thermal cut-out. If for any reason the unit should overheat, the thermostat will automatically turn the unit off. Should this occur, unplug the steamer from the electrical outlet and turn off the switch. Let the unit cool, remove and empty the water tank. To re-start the machine, plug it into an electrical outlet and switch it back on.

# Getting Started

**CAUTION:** Do not use hot or boiling water to fill water compartment. Do not open the water tank lid when using the steamer. Your steamer is pressurised, do not completely remove the lid when tank is hot. Fill tank only when cool.

**IMPORTANT:** After use, switch off the machine, compress the steam trigger to release all remaining steam. Allow machine to cool for a minimum of 30 minutes before refilling or storing.

## Operating your steam cleaner

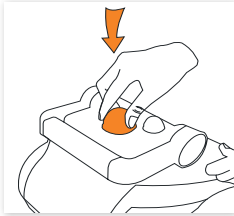

To remove lid push down and twist anti-clockwise.

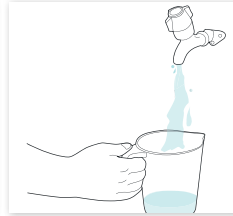
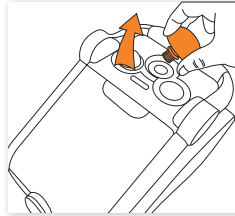

Fill measuring jug to 750ml.

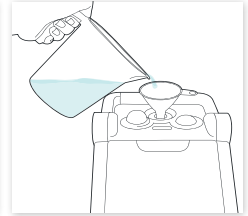

Insert funnel into the water tank to make filling the tank easier. Fill the tank to a maximum 750ml and leave space at the top of tank.

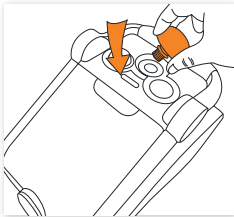

Ensure lid is securely fastened by pushing down and twisting in a clockwise direction.

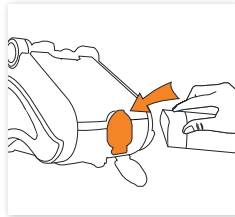

Attach the hose to the unit. When removing the hose, ensure the machine is switched off and fully cooled.

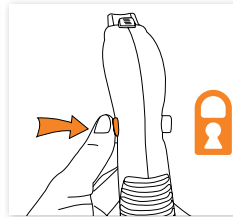

Ensure steam handle safety latch is on before heating.

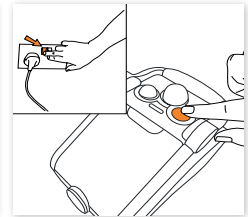

Plug in steamer at the mains, and press ON/OFF button to turn on.

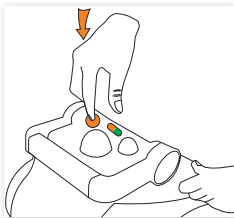

Within 6 minutes your steamer will heat up and will be ready for use.

**Orange** LED = water heating  
**Orange** LED + **Green** LED = steam ready after 6 minutes

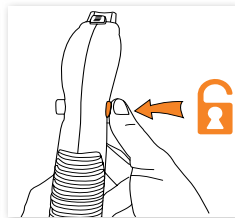

Release steam handle safety latch.

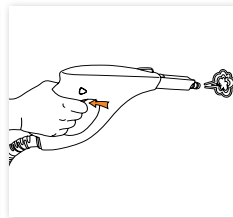

Press steam trigger to release steam.

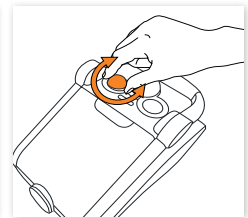

Rotate variable steam dial to adjust steam pressure.

# How To Use

## Accessories

**IMPORTANT:** Never leave the steamer in one spot or any one surface for an extended period of time with a damp/wet pad attached, as this may damage the floor surface.

### Extension tubes

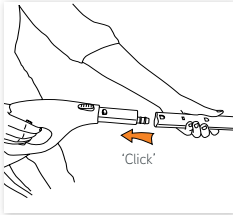

Attach extension tube to handle.

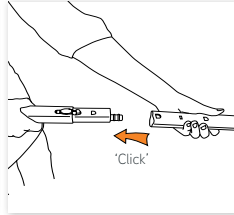

Attach extension tubes together.

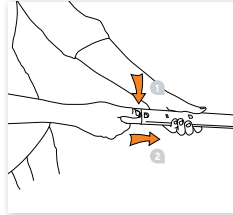

To remove/release tubes, press latch as shown.

### Floor head

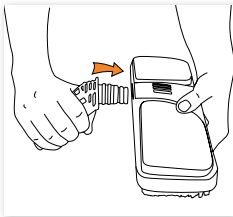

Attach the floor head connector to the floor head.



Rotate floor head connector into place.

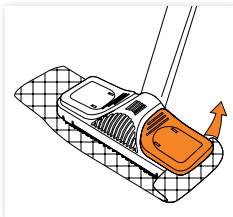

Lift levers on either side of the floor head to secure floor cloth.

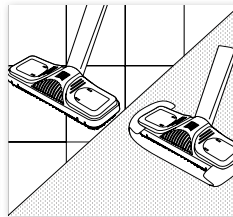
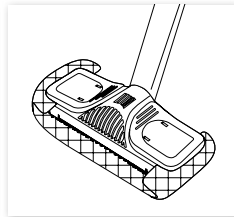

### Attaching small tools

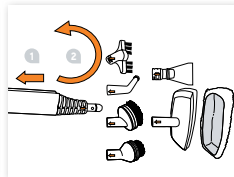
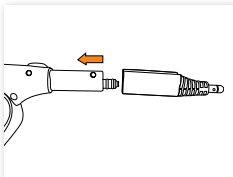

Push small tools onto concentration nozzle aligning arrows.

Twist clockwise to fit.

Note: Concentration nozzle must be attached before fitting the small tools.

## Accessories

**IMPORTANT:** Test for colour fastness in a small hidden area of upholstery/fabric to check for colour removal before use. When cleaning the tap, the tap should be off. Before cleaning the oven, it should be off and cooled to room temperature.

### Using the small tools

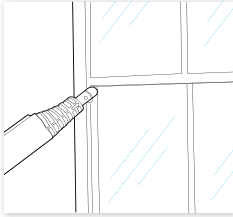

#### Concentration nozzle

Use to remove soap scum in baths and shower enclosures and to clean heavily soiled areas in kitchens.

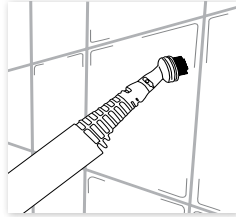

#### Brushes

Ideal for any surface from tiles, sinks, toilets and over taps.



#### Grout brush

Lifts embedded dirt from inbetween tiles.

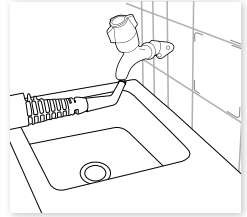

#### Detail tool

For hard to reach areas e.g. around taps.

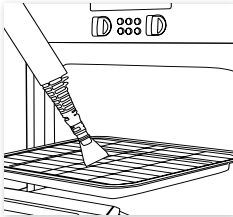

#### Scraper tool

Ideal for removing dried on residue from in ovens, work surfaces and pans.



#### Window squeegee tool

Great for leaving your windows, tiles and mirrors gleaming.

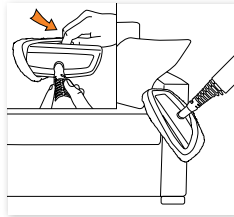

#### Upholstery/clothes tool

Attach the cloth to the squeegee tool for use on upholstery and clothes.

# Looking After Your Machine

## Cleaning cloths

**IMPORTANT:** Never use bleach or fabric softener when washing cloths.

Wash by hand or machine washable at a 'warm' (max 40° c) temperature. Always use a mild detergent.

Allow to fully dry before next use.

## Storage

**IMPORTANT:** Steam cleaner must have cooled down for a minimum of 30 minutes before emptying of water and storing.

**IMPORTANT:** To maintain your steam cleaner's performance, when storing your machine turn the unit off at the plug and hold steam trigger down to release remaining steam pressure. Ensure the water tank has been fully drained before storing.

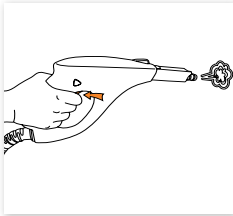

Press steam trigger to release steam.

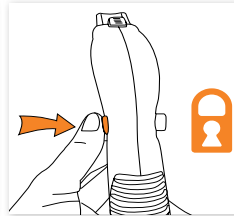

Ensure steam handle safety latch is on.

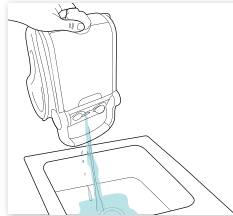

Empty unit of any remaining water.

## Cleaning your steam cleaner

**IMPORTANT:** Always ensure before cleaning or maintaining the steam cleaner that it is switched off, unplugged from the mains and cooled down to room temperature. Only clean the steam cleaner by wiping over the housing with a slightly moistened cloth. Do not use any cleaning agents, abrasives or alcohol since they may damage the housing. Vax recommend that the tank be rinsed out after 5 filling operations at the latest if water hardness is above 1.8 mmol/l (10°d/H). Information regarding local water hardness may be obtained from the water or utility company. Vax recommend filling the water tank with water and giving it a good shake to clean it. This will loosen any limescale that has been deposited on the bottom of the steam cleaner. Pour out the water and allow the tank to dry out completely before closing it. The water tank should be treated with limescale remover approx. every 6 months to prolong the steam cleaner's life. Place one (or at most two) limescale removal sticks in 0.75 litre of warm water (50°C) and fill the water tank with it. Allow the solution to work for approx. 30 minutes then pour away the water with the dissolved solids. Repeat this process if necessary then rinse out the tank with water.



**WARNING:** To reduce the risk of personal injury, unplug the steamer and ensure the unit has fully cooled down before performing maintenance/troubleshooting checks.

## Is there an accessory missing?

- Check the parts overview page in this guide to make sure the part is definitely included with your machine.
- If the part is missing, we're here to help. Simply call us on: **0844 412 8455**

## What do I do if the machine/an accessory has become damaged or broken?

- Visit [vax.co.uk](http://vax.co.uk) for spares and parts.
- Please call our Careline to purchase new spares or order a replacement.

## What do I do if the steam cleaner has no power?

- The unit may not be plugged into an electrical socket; ensure the plug is pushed in securely.
- Check the electrical socket is switched on.
- The electrical socket may not be working; check the fuse or breaker and consult an electrician.
- The power cord may be damaged; call us on **0844 412 8455**

## Why is the steam cleaner not producing steam?

- Ensure that the mains power is switched on and the power button has been pressed on the unit.
- There may be no water in the tank; please refer to the operation section.
- Check that the safety latch has been unlocked on the steam handle.

- Check that the unit has not been overfilled as there must be space in the tank for the water to heat. If overfilled the unit will deliver little steam or water droplets.
- The water may not yet be at temperature; the green steam ready indicator light will illuminate when the water is at temperature and is ready to use.
- If the unit is producing a very small amount of steam, check the variable steam power dial and adjust to max.
- When the unit has been switched off and fully cooled, remove the water tank lid. If limescale build up can be seen inside the tank, the unit will need to be de-scaled.
- If none of the points above are of assistance, we're here to help. Simply call us on: **0844 412 8455**

## What do I do if the steam cleaner takes a long time to heat up?

- When the unit has been switched off and fully cooled, remove the water tank lid. If limescale build up can be seen inside the tank, the unit will need to be de-scaled.
- Otherwise, we're here to help. Simply call us on: **0844 412 8455**

**we're here if you need us**

Instead of taking me back to the shop, simply visit;

**[vax.co.uk/support](http://vax.co.uk/support) • [vaxireland.ie](http://vaxireland.ie)**  
or call:

(UK) 0844 412 8455 (ROI) 1-800 928 308

This does not affect your statutory rights.







Vax Ltd., Kingswood Road, Hampton Lovett, Droitwich, Worcestershire, WR9 0QH, UK email: [info@vax.co.uk](mailto:info@vax.co.uk)  
website: [vax.co.uk](http://vax.co.uk)