

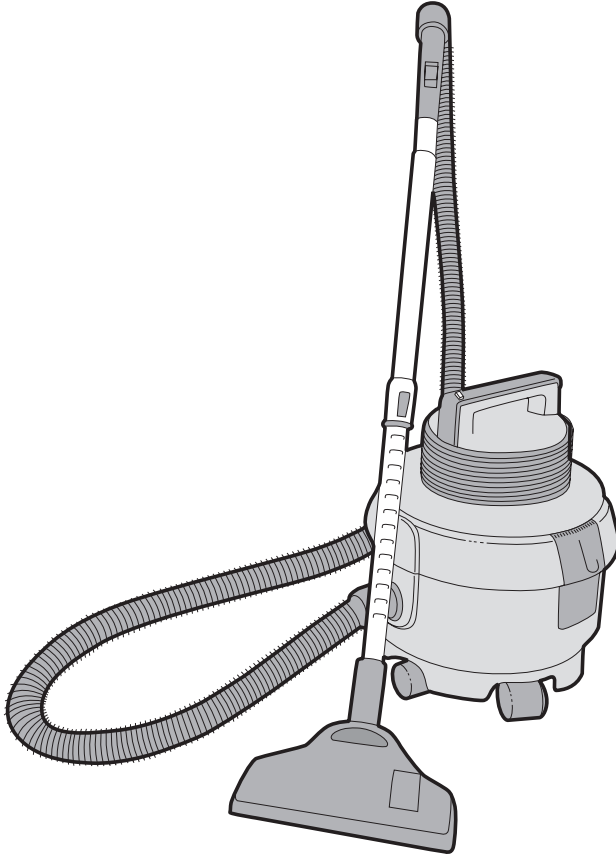

[www.vax.co.uk](http://www.vax.co.uk)

**Vax Careline:  
0870 6061248**



**vax**  
**pro**  
dry vac

**BAGGED CYLINDER VACUUM CLEANER**

**Vax Model Number: V-100**

**Please read carefully before using  
this cleaner. Always fully extend  
the mains cable before use.**

**Instruction Manual**

# 1. Parts Overview

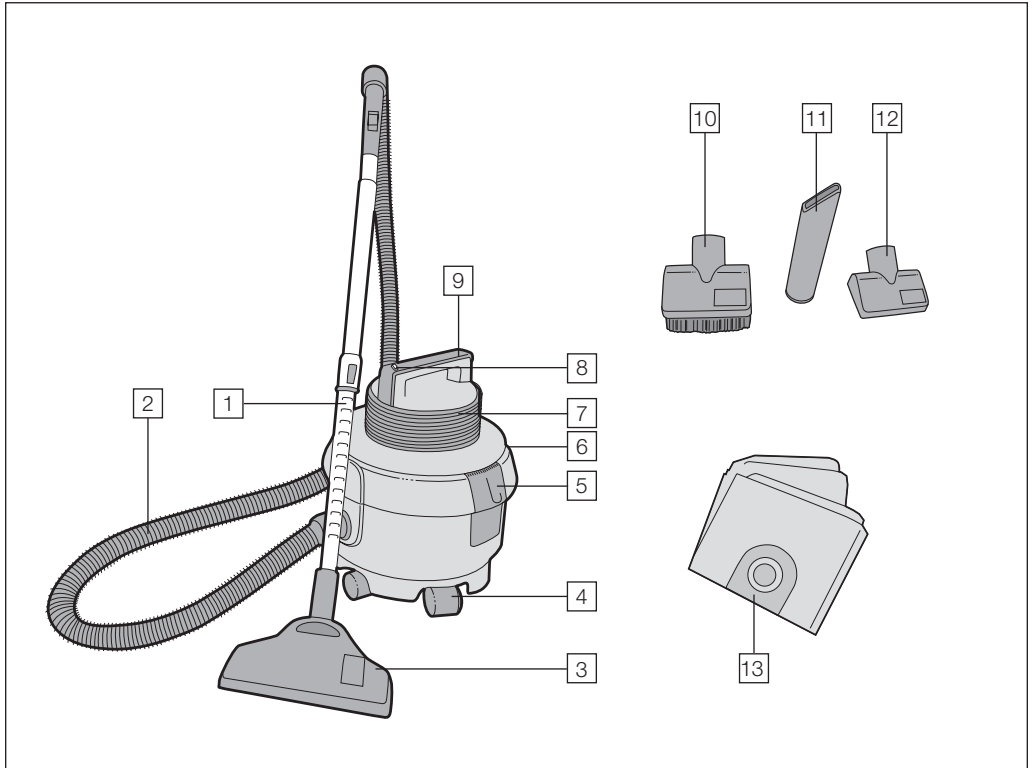

Fig. 1/1

- |   |                             |    |                 |
|---|-----------------------------|----|-----------------|
| 1 | Telescopic extension tube   | 8  | On/off button   |
| 2 | Flexible hose               | 9  | Carry handle    |
| 3 | Combination floor tool      | 10 | Dusting brush   |
| 4 | Castor wheels               | 11 | Crevice tool    |
| 5 | Top cover retainer clips    | 12 | Upholstery tool |
| 6 | Post-motor filter (at rear) | 13 | Dust bags (x5)  |
| 7 | Power cord                  |    |                 |

**IMPORTANT:** The accessories are stored in the dust bag compartment and need to be removed before operating the vacuum cleaner.

## 2. Safety Information

### FOR HOUSEHOLD USE ONLY.

When using the vacuum cleaner, basic safety precautions should always be observed, including the following:

1. Only use the vacuum cleaner indoors on dry surfaces.
2. Turn off the vacuum cleaner controls before connecting to or disconnecting from the mains supply.
3. Always unplug the vacuum cleaner before connecting or disconnecting the vacuum hose.
4. Close attention is necessary when used by or near children. Do not allow children to use as a toy.
5. Use only as described in this manual. Use only the manufacturer's recommended attachments.
6. Do not use the vacuum cleaner if it has been dropped, damaged, left outdoors or dropped into water. Do not use the vacuum cleaner with a damaged cord or plug. If the supply cord or plug is damaged, return the vacuum cleaner to a Vax Authorised Service Agent or suitably qualified person for examination, repair or adjustment.
7. Do not pull or carry by the cord. Do not use the cord as a handle, close a door on the cord or pull the cord around sharp edges or corners. Do not run the vacuum cleaner over the cord. Keep the cord away from heated surfaces.
8. Do not handle the plug or vacuum cleaner with wet hands. Do not use outdoors or on wet surfaces.
9. Do not put any objects into openings. Do not use with any openings blocked and do not restrict air flow. Keep all openings free of dust, lint, hair or anything that may reduce airflow.
10. Keep hair, loose clothing, fingers and all parts of the body away from openings and moving parts.
11. Do not pick up hot coals, cigarette butts, matches or any hot, smoking or burning objects.
12. Do not pick up flammable or combustible materials (lighter fluid, petrol, kerosene, etc) or use in the presence of explosive liquids or vapours.
13. Do not vacuum up harmful or toxic material (chlorine bleach, ammonia, drain cleaner, etc).
14. Do not vacuum up hard or sharp objects such as glass, nails, screws, coins, etc.
15. Do not use without the filters in place.
16. Take extra care when vacuuming on stairs.
17. Keep vacuuming area well lit.

18. Store the vacuum cleaner indoors in a cool, dry area.
19. Turn off the switch before unplugging.
20. Use only CE-approved 13 amp extension cords. Non-approved extension cords may overheat. Care should be taken to arrange the cord so that the cord cannot be pulled or tripped over.

**WARNING:** Always switch off and unplug the vacuum cleaner from the electrical outlet before assembling, opening or replacing the dust bag, or before connecting/disconnecting the attachments.

**CAUTION:** The vacuum cleaner is a very powerful unit. Before plugging the cord into the electrical outlet make sure the switch is in the 'off' position. Hold the vacuum cleaner firmly when starting and in use.

**IMPORTANT:** If the inlet or hose is blocked, switch off the vacuum cleaner and remove the blockage(s) before re-starting the vacuum cleaner.

**IMPORTANT:** Replacing filters and changing the dust bag improves vacuum performance. Make sure the foam filter sleeve is completely dry before inserting back into the vacuum cleaner.

This vacuum cleaner is intended for household use only and not for commercial or industrial use.

PLEASE KEEP THESE INSTRUCTIONS FOR FURTHER USE.

### Motor Thermostat

**IMPORTANT:** The motor is equipped with a thermal cut-out. If for any reason, the vacuum cleaner should over-heat, the thermostat will automatically turn the unit off. Should this occur, unplug the vacuum cleaner from the wall outlet and turn off the switch. Open the unit and check the dust bag. If full, replace. Wash the foam filter sleeve. Allow the cleaner to cool for approximately one (1) hour.

To re-start, plug into a wall outlet and switch back on.

### 3. Initial Set Up

**IMPORTANT:** The accessories are stored in the dust bag compartment and need to be removed before operating the vacuum cleaner.

1. Unclip the retainer clips on either side of the vacuum cleaner and lift off to gain access to the dust bag compartment (Fig.3/1).

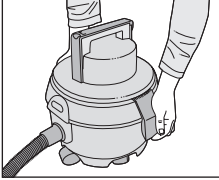

Fig.3/1

2. Remove the accessories (Fig.3/2).

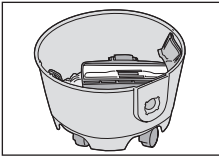

Fig.3/2

3. Fit the dust bag by aligning the front of the dust bag with the inlet slots (Fig.3/3).

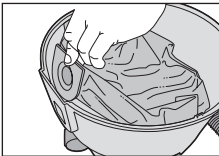

Fig.3/3

4. Position the dust bag to fill the inside of the bin (Fig 3/4).



Fig.3/4

5. Replace motor top.

### 4. Use and Function

**IMPORTANT:** Always remove the power plug from the wall outlet before assembling or before removing accessories.

1. Insert the flexible hose into the inlet on the main body of the vacuum cleaner. Push in and twist clockwise a quarter turn until tight (Fig.4/1).

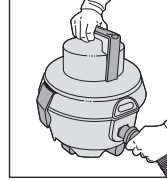

Fig.4/1

2. Push the telescopic extension tube onto the end of the handle (Fig.4/2).

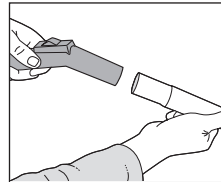

Fig.4/2

3. The telescopic extension tube can be lengthened or shortened by pushing the button in and sliding the tubes apart or together as required (Fig.4/3).

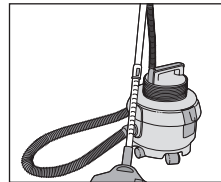

Fig.4/3

4. Fit the combination floor tool by pushing on to the extension tube (Fig 4/4).

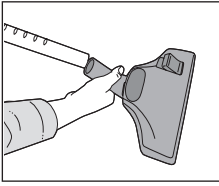

Fig. 4/4

## Hard Floor Cleaning

For hard floor cleaning, press the rocker switch on the combination floor tool as shown to lower the brushes (Fig.5/3).

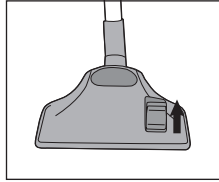

Fig. 5/3

## 5. How to Operate

### On/off Button

Fully unwind the power cord and plug the cord into the electrical outlet. Turn the vacuum cleaner on by depressing the button located on the top of the carry handle (Fig.5/1). The vacuum cleaner can be turned off by pressing the on/off button again.

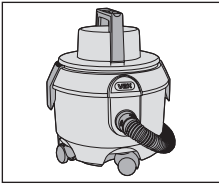

Fig.5/1

### Cord Wrap

After use, turn the vacuum cleaner off and unplug from the electrical outlet. Wrap the cord around the top section of the vacuum cleaner and secure in place with the cord clip (Fig.5/4).

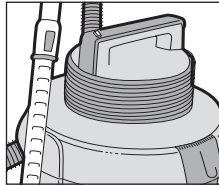

Fig.5/4

### Carpet Cleaning

For carpet cleaning, press the rocker switch on the combination floor tool as shown to raise the brushes (Fig.5/2).

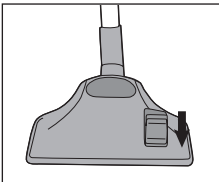

Fig.5/2

### Carry Handle

Use the carry handle located on the top of the vacuum cleaner to move from room to room (Fig.5/5).



Fig.5/5

## 6. Accessories

**IMPORTANT:** Always remove the power plug from the wall outlet before assembling or before removing accessories.

1. The accessories can be attached directly to the handle by removing the telescopic tubes and pushing in the desired accessory (Fig.6/1).

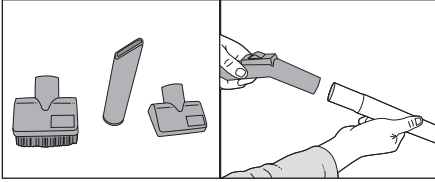

Fig.6/1

2. The accessories can also be attached to the telescopic extension tube for extra reach. Remove the combination floor tool and push on the desired accessory (Fig.6/2).

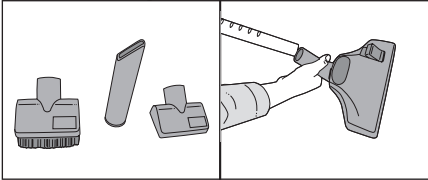

Fig.6/2

**Crevice Tool:** For crevices, corners, cracks etc.

**Dusting Brush:** For delicate surfaces.

**Upholstery Tool:** For carpet, upholstery, stairs etc.

## 7. Dust Bag & Filters: Removal & Replacement

**IMPORTANT:** Always unplug the vacuum cleaner from the electrical outlet before removing the dust bag.

**IMPORTANT:** DO NOT use the vacuum cleaner without ALL of the filters in place.

1. Turn off the vacuum cleaner and unplug it from the mains. Remove the hose. Unclip the retainer clips on either side of the vacuum cleaner and lift off to gain access to the dust bag compartment (Fig.7/1).

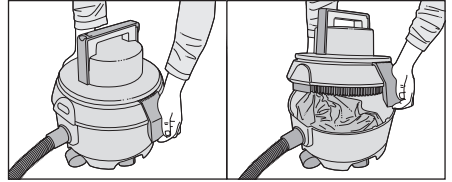

Fig.7/1

2. Lift out the full dust bag (Fig.7/2).

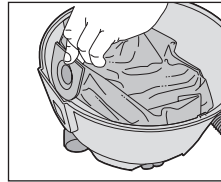

Fig.7/2

3. Dispose of the full dust bag and insert a new dust bag back into the vacuum cleaner aligning the front of the dust bag with the inlet slots (Fig.7/3).

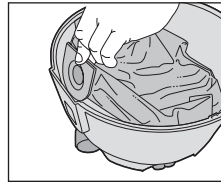

Fig.7/3

### Pre-motor Filter

1. Turn off the vacuum cleaner and unplug it from the mains. Unclip the retainer clips on either side of the vacuum cleaner and lift off to gain access to the dust bag compartment (Fig.7/4).

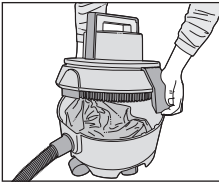

Fig.7/4

2. The pre-motor filter is found on the underside of the top cover. To release the filter turn the cover anti-clockwise and lift away (Fig.7/5).

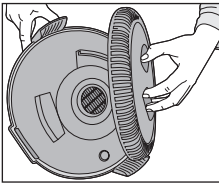

Fig.7/5

3. The pre-motor filter is protected by a foam filter sleeve. This can be washed using cold water, leaving it to fully air dry before replacing (Fig.7/6).

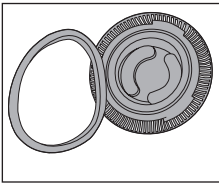

Fig.7/6

4. The pre-motor filter should be replaced every 9-12 months.

### Post-motor Filter

1. Located at the rear of the vacuum cleaner is a post-motor filter which can also be removed and replaced.
2. Push in on the latches on both sides of the filter cover to release to post-motor filter (Fig.7/7).

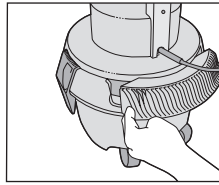

Fig.7/7

3. Remove the post-motor filter (Fig.7/8).

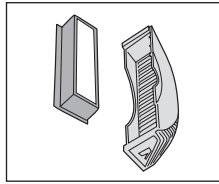

Fig.7/8)

4. The post-motor filter should be replaced every 9-12 months.

## 8. Clearing Blockages

1. Switch the vacuum cleaner off and disconnect the power plug from the electrical outlet.
2. The flexible hose can be disconnected from the vacuum cleaner by rotating anti-clockwise and pulling away from the machine (Fig.8/1). Remove any blockages found then reconnect the hose securely.

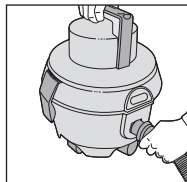

Fig.8/1

## 9. Troubleshooting

### **WARNING: TO REDUCE RISK OF PERSONAL INJURY, UNPLUG VACUUM CLEANER BEFORE SERVICING**

#### **PROBLEM: Cleaner won't run**

**Cause:** Not properly plugged into electrical outlet.

**Solution:** Plug in firmly.

---

**Cause:** No electricity in electrical outlet.

**Solution:** Check fuse or breaker.

---

**Cause:** On/off switch not turned on.

**Solution:** Push on/off switch to on.

---

**Cause:** Motor thermostat has tripped.

**Solution:** Switch off and unplug cleaner. Leave for one (1) hour before switching the cleaner back on.

---

**Cause:** Blown fuse/tripped breaker.

**Solution:** Reset circuit breaker or replace fuse.

---

#### **PROBLEM: Vacuum cleaner won't pick up/loss of suction**

**Cause:** Dust bag not installed correctly.

**Solution:** Review dust bag removal and replacement.

---

**Cause:** Dust bag full or blocked.

**Solution:** Replace dust bag.

---

**Cause:** Clogged filter.

**Solution:** Remove filter and clean.

---

**Cause:** Blockage in hose.

**Solution:** Disconnect hose, remove obstruction then re-fit.

---

#### **PROBLEM: Accessories won't pick up**

**Cause:** Accessories not attached correctly.

**Solution:** Refer to page 5 for fitting information.

---

#### **PROBLEM: Dust escaping from the vacuum cleaner**

**Cause:** Dust bag full.

**Solution:** Dispose of dust bag and replace with a new one.

---

**Cause:** Dust bag not installed correctly.

**Solution:** Review dust bag removal and replacement.

---

**Cause:** Hose not installed correctly.

**Solution:** Review hose installation.

---

**Cause:** Filter not installed completely.

**Solution:** Review filter removal and replacement.

---

# 10. Guarantee Terms & Conditions for V-100 Vax Pro

Vax Ltd guarantees this vacuum cleaner to be free from defects in material or workmanship commencing upon the date of the original purchase. Save your original sales receipt to validate the start of warranty period.

If the vacuum cleaner should become defective within the first two years, Vax will repair or replace any defective parts free of charge (details of parts excluded are in the conditions below).

The complete machine must be delivered to any Vax authorised service agent along with proof of purchase (for full terms and conditions see below).

After the two year period has expired, Vax will guarantee the main unit for parts only for three years (for full terms and conditions see below).

## 1 OUR COMMITMENT TO YOU

1.1 Vax promise that, provided you use the Product in accordance with the operating instructions for normal domestic purposes:

- (a) the Product should be free from defects in design, materials, workmanship and manufacture for 2 years from the date of purchase (the "Initial Guarantee Period"); and
- (b) for an additional three years after the expiry of the Initial Guarantee Period (the "Additional Guarantee Period") the main unit of the Product should be free from defective parts.

1.2 Please note however that our commitment to you is subject to the terms of this Guarantee. In particular, please read Section 1.4, Section 2 (Important Exceptions from our commitment to you), Section 3 (Transfer of our Commitments) and Section 5 (Limits to our responsibility).

1.3 If Vaxis in breach of our commitments then, subject to the other terms of this Guarantee, Vax will pay the cost of parts and labour during the "Initial Guarantee Period" and for the cost of parts only during the "Additional Guarantee Period". Please refer to Section 4 of this guarantee for details of how to make a claim under this Guarantee.

1.4 Our commitment to you is only valid if you are a consumer (not a business) [living] in mainland

United Kingdom. If you live outside mainland United Kingdom (or unsure if this covers you) please contact your local Vax Approved Service Agent.

## 2 IMPORTANT EXCEPTIONS FROM OUR COMMITMENT TO YOU

2.1 Please note that our commitment (and this Guarantee) does not cover:

- (a) Products that have been used for anything other than normal domestic purposes.
- (b) Products that have not been used in accordance with instructions which are set out in the documentation provided with your Product;
- (c) Products which are only damaged cosmetically;
- (d) Products which are deliberately or accidentally damaged;
- (e) Problems with the Product which result from your negligence;
- (f) Regular maintenance or servicing including the clearing of blockages from the hose and tools;
- (g) Products which have been damaged as a result of bags, filters, fluids or accessories which are not of a specification or quality that we provide or recommend;
- (h) Consumable items including bags and filters;
- (i) Products which have been damaged as a result of consumable items such as bags and filters not being regularly cleaned and replaced;
- (j) Products which have been exposed to fire, water, excessive moisture or dampness or extreme change in temperature or climate;
- (k) Products which have been opened up, repaired or altered by anyone other than a Vax Approved Service Agent;
- (l) Damage or loss to Product occurring during transit to or from the Vax Approved Service Agent.
- (m) The replacement of perishable items including hoses, cables, attachments and floor tools; and
- (n) Costs associated with callout, collection of the Product; and
- (o) Cost of repair of the Product during the Additional Guarantee Period.

### 3 TRANSFER OF OUR COMMITMENTS TO YOU

- 3.1 You cannot transfer our commitments (and this Guarantee) to another person. Our commitments (and this Guarantee) will terminate if you transfer the Product to another person.

### 4 WHAT VAX WILL DO IF THEY BREAK THEIR COMMITMENTS TO YOU

- 4.1 If Vax break their commitment to you during the relevant Guarantee Period, Vax will seek to remedy the problem. Vax may do this:
- (a) By repairing the Product for you; or
  - (b) By replacing the Product with a new or rebuilt Product; or
  - (c) (in the Additional Guarantee Period) by providing you with a replacement part.]
- 4.2 If Vax provides a rebuilt Product Vax will ensure that the refurbished parts are of similar quality and functionality to your original Product before the problem arose.
- 4.3 So that Vax can provide you with a remedy you must return the Product to one of our Vax Approved Service Agents. You can find details of our Vax Approved Service Agents by contacting the Vax Careline on 0870 6061248 or by visiting [www.vax.co.uk](http://www.vax.co.uk).
- 4.4 You must include with the returned Product, proof of purchase showing that it was purchased by you and is within the relevant Guarantee Period.
- 4.5 If Vax repair or replace the Product under this section 4 then Vax will give you the same commitments in relation to the repaired or replaced Product. However, these commitments will only apply for the remainder of the Guarantee Period and Additional Guarantee Period relating to your original Product or for 30 days, whichever period is longer.

### 5 LIMITS TO OUR RESPONSIBILITY

- 5.1 Vax accept full liability to you:
- (a) for death or personal injury if it arises from our act or omission; and
  - (b) for any fraud Vax may commit.
- Nothing in this Guarantee will exclude or limit that liability.
- 5.2 Neither ourselves, our suppliers nor our dealers will be liable to you for loss that you suffer which was not foreseeable to you and us when you purchased the Product (i.e. for losses that you and we did not anticipate and would not reasonably expect to occur).

### 6 GENERAL

- 6.1 No person other than you and Vax Limited has any rights under this Guarantee.
- 6.2 This Guarantee is subject to English law. Any court proceedings must be brought in the United Kingdom.

If you have any queries about how to obtain a remedy if Vax break its commitments to you, then please contact the dealer from whom you purchased the Product.

## 11. UK Service & Help Vax Care 0870 6061248

Monday-Friday 9.00am to 5.00pm.

An answerphone is available out of these hours. Any queries or concerns about using the Vax, call the Vax Careline. Calls are charged at the UK national rate.

Please make a note of the serial number and model number of the carpet cleaner before calling. There are over 400 approved Vax Service Agents in the UK. For the nearest Service Agent, please call the Vax Careline.

[www.vax.co.uk](http://www.vax.co.uk)

## 12. Technical Specification

Voltage:	220-240V ~50Hz
Wattage:	1100W (nom)
Capacity:	10 litres max
Filters:	Pleated paper HEPA pre-motor filter Pleated paper HEPA post-motor filter
Cord length:	10m
Weight:	6.77kg

Subject to technical change without notice.



---

**This page has been intentionally left blank.**

### **EEC STATEMENT OF COMPLIANCE**

Manufacturer/EEC importer: Vax Limited, hereby on our own responsibility declare that the product V-100 Vax Pro is manufactured in compliance with the following:  
Safety: 73/23/EEC Low Voltage Directive, as modified by 93/68/EEC  
EMC: 89/336/EEC Electromagnetic Compatibility Directive, as modified by 93/68/EEC



Waste electrical products should not be disposed of with household waste. Please recycle where facilities exist. Check with your Local Authority or retailer for recycling advice.

Vax Ltd., Kingswood Road, Hampton Lovett, Droitwich, Worcestershire, WR9 0QH, UK  
email: [info@vax.co.uk](mailto:info@vax.co.uk) - website: [www.vax.co.uk](http://www.vax.co.uk)