

# Handheld Vac

## INFINITY

by **vax**

Vax careline

0870 6061248



For you free 1 year parts and labour guarantee  
please register at: [vax.co.uk/guarantee/s](http://vax.co.uk/guarantee/s)

Vax model number: V-039 Series

instruction manual

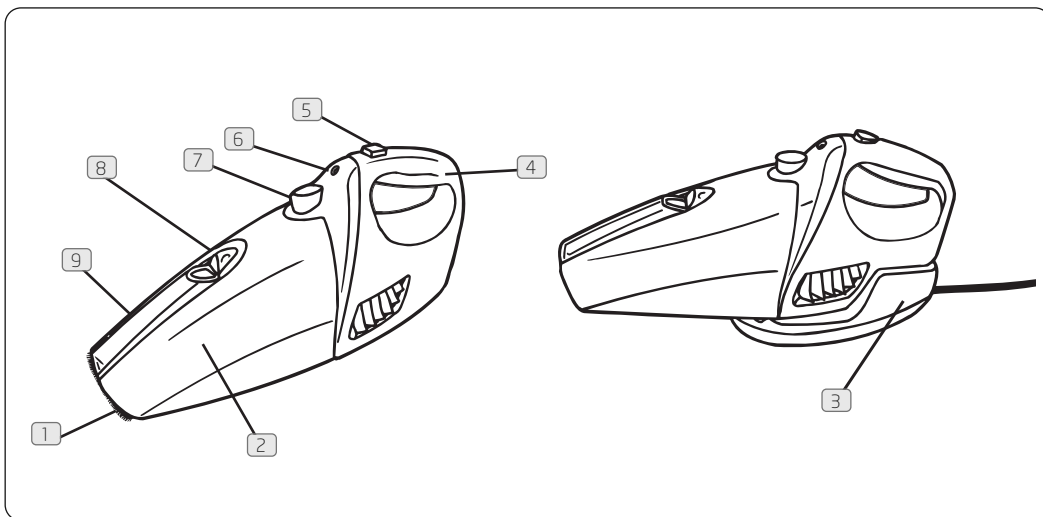

## 1. Parts Overview

### The Unit

- ① Retractable bristles For delicate surfaces
- ② Dirt cup
- ③ Charging /storage base
- ④ Handle
- ⑤ On/Off Switch
- ⑥ Charging light\*
- ⑦ Dirt cup release button
- ⑧ Crevice tool release button
- ⑨ Crevice tool For crevices, corners and cracks

\*Charging light turns off when Hand Vac is fully charged

### What is your vax's model number?

 -    

(on the base of  
your cleaner)

### What is your vax's serial number?

     

(on the base of  
your cleaner)

Note this down in case you need it in future

## 2. Storage / Charging

Designed to sit in the charging base on a flat surface or wall mountable.

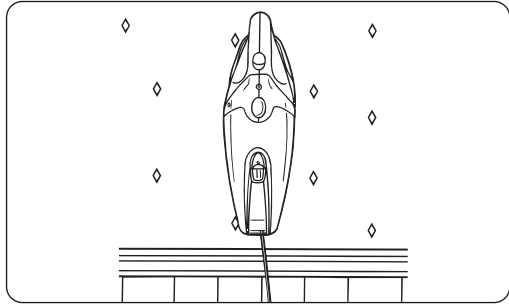
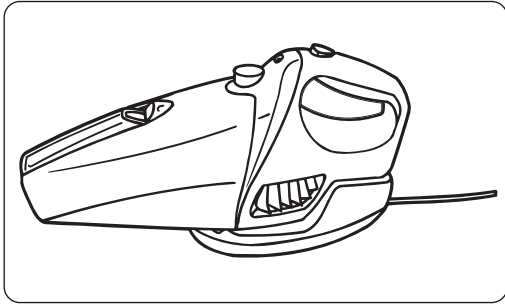

### Charging

**⚠ IMPORTANT:** Use only the charger supplied.

**⚠ IMPORTANT:** Before first use charge your unit for at least 6 hours.

- Power switch must be in OFF position.
- Keep the charger plugged into a standard outlet at all times. It is normal for the charger to become warm to the touch when charging.
- If the operating time gets shorter after repeated use, let the unit run until it stops running. Recharge for 6 hours and repeat monthly for best results.
- Charging light turns off when the hand vac is fully charged.

### Unit Storage

- Hold the unit by the handle and push down firmly into the charging base.
- Ensure the red charging light is on.

## 3. Operating the appliance

To use: Slide the power switch to the ON position.

To turn off: Slide the power switch to the OFF position.

**NOTE:** Empty and clean the unit and filter after each use or large pick ups when the unit becomes full.

## 4. Choose the Attachment

**NOTE:** The crevice tool is permanently stored on-board. It is located on the top of the dirt cup for your convenience.

To use

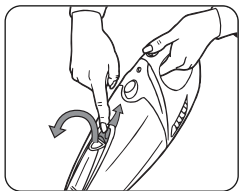

To store

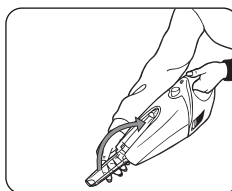
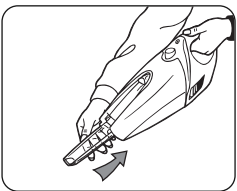

Retractable bristles

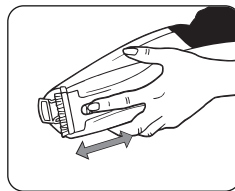

## 5. Dirt Container: Maintenance

**NOTE:** Each time the dirt cup is emptied the filter should be cleaned. Tap the filter firmly against the inside of a dirt bin, until the dirt stops falling from the filter. (The filter will discolour after use but will not affect performance). Do not brush the filter. Depending on the dirt conditions the filter may require more or less cleaning.

**⚠ IMPORTANT:** Do not wash filter

Depress the dirt cup release button and pull nozzle away from unit.

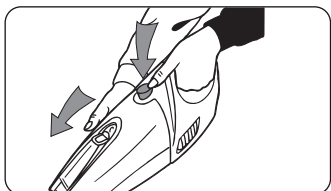

Hold nozzle over a bin. Grasp filter and gently pull out.

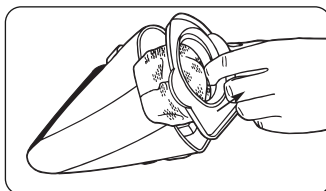

Shake excess dirt and debris out of dirt cup. For best results, tap filter against a bin to remove remaining dirt.

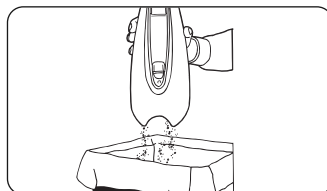

Gently push filter back into dirt cup.

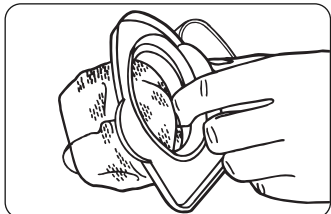

To reattach dirt cup: Align bottom first and rotate nozzle up, until it snaps into place.



## 6. The Filters: Maintenance

**⚠ WARNING:** To reduce the risk of injury from moving parts - unplug the hand vac before servicing or changing the filter.

Remove dirt cup from unit. Grasp tab and pull filter assembly.

Twist old filter to remove from filter adapter.

Twist and lock new filter into filter adapter.

Return filter assembly to dirt cup. Return dirt cup to base of unit.

**⚠ IMPORTANT:** Do not discard filter adapter

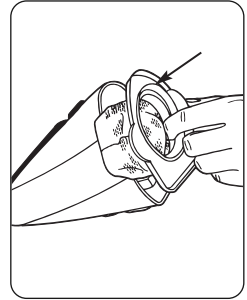
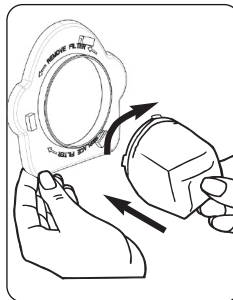
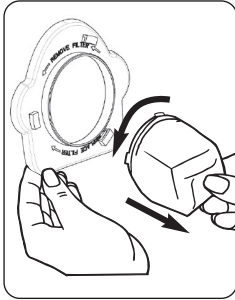
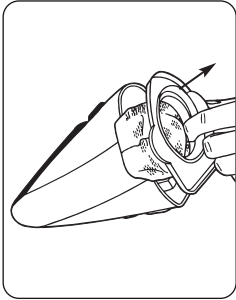

## 7. Battery Disposal

Your handheld Vax contains a nickel metal hydride battery.

When your hand vac battery no longer recharges or you want to dispose of the battery please call vax careline on 0870 606 1248 for correct removal and disposal of the battery.

Waste electrical products should not be disposed of with household waste.



## 8. FAQs

 **WARNING:** to reduce the risk of personal injury, unplug the hand vac cleaner before performing maintenance/troubleshooting checks

### Why will the hand vac not run?

- The battery may not be charged. To charge the battery, the power switch must be in 'OFF' position. The red light shows the unit is charging and will switch off when fully charged. The initial charge should be for 6 hours.
- Contacts between the unit and the base may be dirty - wipe dirt from the contact points.
- The electrical outlet may not be working: check the fuse or breaker and consult an electrician.

### Why won't the vacuum cleaner pick up?

- The nozzle or dirt passage may be blocked, remove the obstruction.
- The filter may be clogged or dirty, clean and replace the filter.
- The battery charge is getting weak, let the battery run until it stops and recharge.
- The dirt container is full, empty the container.

### Why won't the battery recharge?

- Contacts between the unit and base may be dirty - wipe dirt from the contact points.
- The electrical outlet may not be working: check the fuse or breaker and consult an electrician
- When the battery won't hold its charge, the battery may be dead. Call Vax careline on 0870 606 12848

If none of these questions apply to you, or for further assistance please call our Vax Careline team on:  
**0870 606 1248**

## 9. Safety Information

### For Household Use Only

When using the hand vac, basic safety precautions should always be observed, including the following:

#### **WARNING: Do not use outdoors or on wet surfaces.**

1. Do not charge the unit outdoors.
2. Turn off the vacuum cleaner control before connecting or disconnecting from the mains supply.
3. Children should be supervised to ensure that they do not play with the appliance.
4. This appliance is not intended for use by persons (including children) with reduced physical, sensory or mental capabilities, or lack of experience and knowledge, unless they have been given supervision or instruction concerning use of the appliance by person responsible for their safety.
5. Use only as described in this manual. Use only the manufacturer's recommended attachments.
6. Do not use with damaged cord or plug. If the appliance is not working, as it should, has been dropped, damaged, left outdoors, or dropped into water, return it to a Vax Authorised Service Agent or suitably qualified person for examination, repair or adjustment.
7. Do not abuse the cord. Keep the cord away from heated surface. Do not pull the cord around sharp edges or corners. Do not close the cord in a door.
8. Do not handle the plug or appliance with wet hands.
9. This product contains a rechargeable Nickel metal hydride battery. Do not throw the battery into fire or expose to high temperatures, as it may burst.
10. Do not use with any opening blocked; keep free of dust, lint, hair, and anything that may reduce airflow.
11. Keep hair, loose clothing, fingers and all parts of the body away from openings and moving parts.
12. Do not pick up hot coals, cigarette butts, matches or anything hot, smoking or burning objects.
13. Do not pick up flammable or combustible materials (lighter fluid, petrol, kerosene, etc) or use in the presence of explosive liquids or vapour.
14. Do not vacuum up harmful or toxic material (chlorine bleach, ammonia, drain cleaner, etc).
15. Do not use without the filter in place.
16. Do not vacuum up hard or sharp objects such as glass, nails, screws, coins, etc.

17. Turn off all controls before unplugging.
18. Take extra care when cleaning on stairs
19. Store the appliance indoors in a cool, dry area.
20. Use only the charge supplied by the manufacturer to recharge.



**IMPORTANT: For dry debris use only.**



**WARNING: Always switch off and unplug the hand vac from the electrical outlet before assembling, opening or emptying the dirt container, or before connecting/disconnecting the attachments.**

This hand vac is intended for household use only and not for commercial or industrial use.

## 10. UK Service & Help

### Vax Care 0870 6061248

**Monday-Friday 8.00am to 8.00pm**

**Saturday-Sunday 9.00am to 5.00pm**

Please make a note of the model number and serial number of your Vax before calling. There are over 400 approved Vax Service Agents in the UK. For the nearest Vax Service Agent, please call the Vax Careline or visit [www.vax.co.uk](http://www.vax.co.uk)

## 11. Technical Specification

Voltage:	230 - 240 ~ 50 Hz
Vacuum motor:	15.6V
Capacity:	0.72
Filters:	Fibre filter (tap to clean)
Cord Length:	1.7m (approx (unit cordless)
Weight:	1.7 kg (approx)



Subject to technical  
change without notice

## 12. EEC Statement of Compliance

Manufacturer/EEC importer: Vax Limited, hereby on our own responsibility, declare that the V-039 Series Infinity by Vax range is manufactured in compliance with the following Directives:

**Safety:** 2006/95/EC Low Voltage Directive

**EMC:** 2004/108/EC Electromagnetic Compatibility Directive



Waste electrical products should not be disposed of with household waste. Please recycle where facilities exist. Check with your Local Authority or retailer for recycling advice.



IN