



Vax careline
0870 6061248

Upright

V-015



Bagless upright vacuum cleaner
Vax model number: V-015

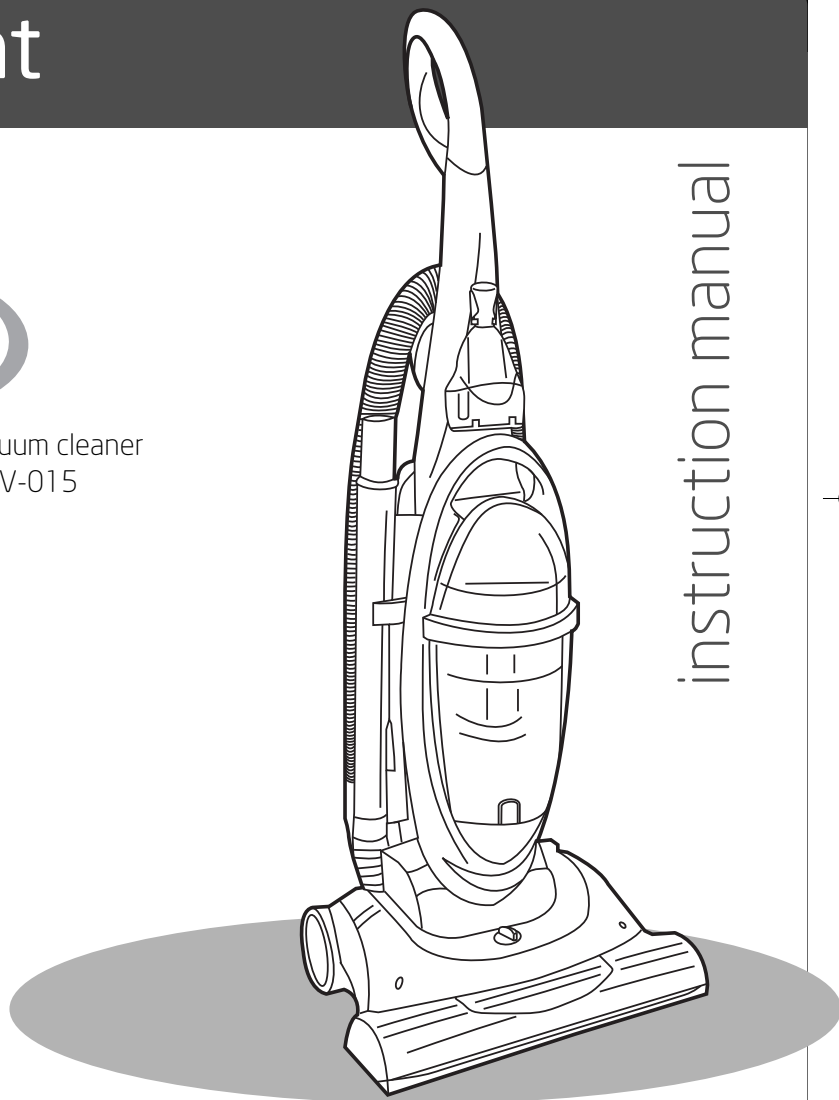

instruction manual

www.vax.co.uk

Please read carefully before using this cleaner.
Always fully extend the mains cable before use.
Retain for future reference.

Vax V-015

1. Diagram

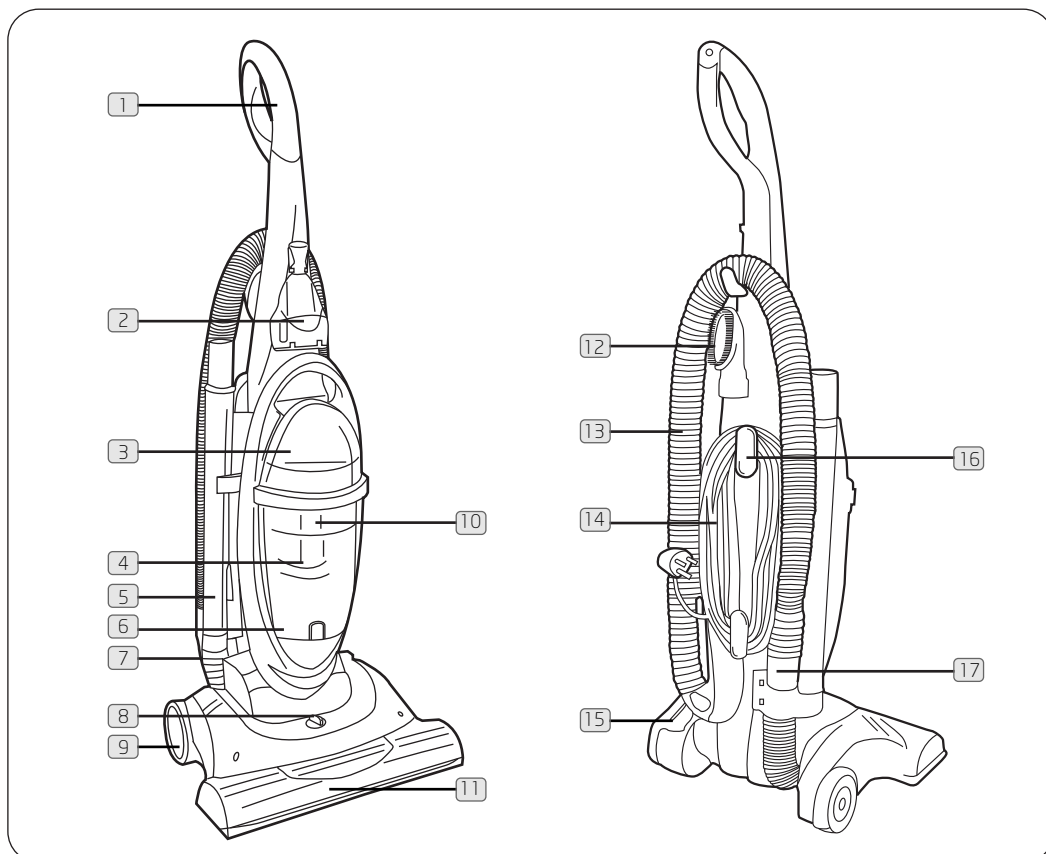

Fig.1/1

- 1 Handle
- 2 TurboTool®
- 3 Dirt container lid
- 4 Dirt Container
- 5 Extension tube
- 6 Dirt container release button
- 7 Crevice tool
- 8 Carpet height adjuster
- 9 Wheel
- 10 Filter
- 11 Vacuum head

- 12 Dusting Brush
- 13 Super stretch hose
- 14 Power Cord
- 15 Handle release pedal
- 16 Upper cord wrap with quick release
- 17 Hose connector

2 parts overview

2. Safety Information

FOR HOUSEHOLD USE ONLY.

When using the vacuum cleaner, basic safety precautions should always be observed, including the following:

1. Only use the vacuum cleaner indoors on dry surfaces.
2. Turn off the vacuum cleaner controls before connecting to or disconnecting from the mains supply.
3. Always unplug the vacuum cleaner before connecting or disconnecting the vacuum hose.
4. Use only as described in this manual. Use only the manufacturer's recommended attachments.
5. Close attention is necessary when used by or near children. Do not allow children to use as a toy.
6. Do not use the vacuum cleaner with a damaged cord or plug. Do not use the vacuum cleaner if it has been dropped, damaged, left outdoors or dropped into water. Return the vacuum cleaner to a Vax Authorised Service Agent or suitably qualified person for examination, repair or adjustment.
7. Do not pull or carry by the cord. Do not use the cord as a handle, close a door on the cord or pull the cord around sharp edges or corners. Do not run the vacuum cleaner over the cord. Keep the cord away from heated surfaces.
8. Do not handle the plug or vacuum cleaner with wet hands. Do not use outdoors or on wet surfaces.
9. Do not put any objects into openings. Do not use with any openings blocked and do not restrict air flow. Keep all openings free of dust, lint, hair or anything that may reduce airflow.
10. Keep hair, loose clothing, fingers and all parts of the body away from openings and moving parts.
11. Do not pick up hot coals, cigarette butts, matches or any hot, smoking or burning objects.
12. Do not pick up flammable or combustible materials (lighter fluid, petrol, kerosene, etc) or use in the presence of explosive liquids or vapours.
13. Do not vacuum up harmful or toxic material (chlorine bleach, ammonia, drain cleaner, etc).
14. Do not vacuum up hard or sharp objects such as glass, nails, screws, coins, etc.
15. Do not use without the filters in place.
16. Use extra care when vacuuming on stairs.
17. Keep vacuuming area well lit.
18. Store the vacuum cleaner indoors in a cool, dry area.
19. Turn off the switch before unplugging.

20. Use only CE-approved 13 amp extension cords. Non-approved extension cords may overheat. Care should be taken to arrange the cord so that the cord cannot be pulled or tripped over.

 **WARNING:** Always switch off and unplug the vacuum cleaner from the electrical outlet before assembling, opening or emptying the dirt container, or before connecting/disconnecting the attachments.

 **CAUTION:** The vacuum cleaner is a very powerful unit. Before plugging the cord into the outlet make sure the switch is in the 'off' position. Hold the vacuum cleaner firmly when starting and in use.

 **IMPORTANT:** If the vacuum inlet or hose is blocked, switch off the vacuum cleaner and remove the blockage(s) before re-starting the vacuum cleaner.

 **IMPORTANT:** Cleaning filters improves vacuum performance. Make sure all filters are replaced back into the vacuum cleaner before using.

 **IMPORTANT:** The motor is equipped with a thermal cut-out. If, for any reason, the vacuum cleaner should over-heat, the thermostat will automatically turn the unit off. Should this occur, unplug the vacuum cleaner from the electrical outlet and turn off the switch. Remove the dirt container and empty. Clean the filters. Allow the cleaner to cool for approximately one (1) hour. To re-start, plug into the electrical outlet and switch back on.

This vacuum cleaner is intended for household use only and not for commercial or industrial use.

PLEASE KEEP THESE INSTRUCTIONS FOR FURTHER USE.

3. Use and Function

Slide the handle onto the top of the main body of the vacuum.

Insert double pronged hole cover into front screw holes (located behind the carry handle).

Secure in place using the two long Phillips head screws provided.

Assembly of the Hose: Screw in appropriate end of the hose into the hold in between the cord holders. Feed hose through the base holding point, clip into side clip, loop over top holding point (see Fig.3/1) and feed into hose connector (see Fig.3/2).

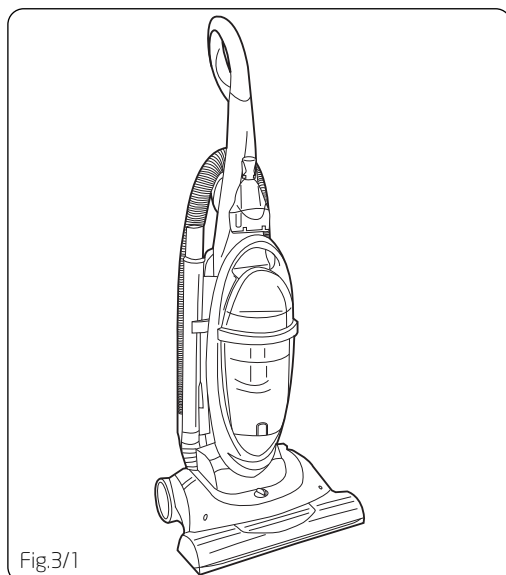

Fig.3/1

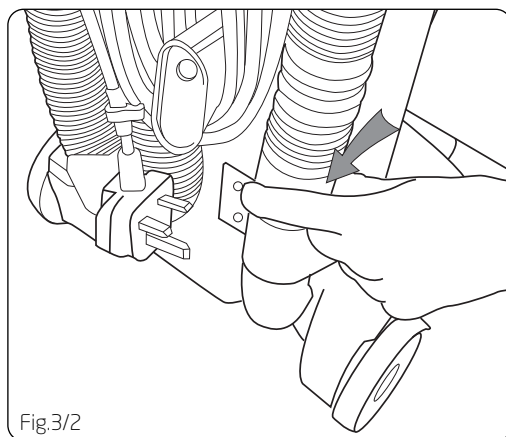

Fig.3/2

Cord storage: To neatly store the power cord, wrap around the two cord holders and then using the clip (found just below the plug head) attach to the cord itself.

To turn on the vacuum press the on/off switch located midway up on the right hand side. Pressing this switch again turns off the cleaner.

To adjust the angle of the main body push the release pedal on the lower left side of the cleaner. This then frees the movement of the unit for greater mobility (Fig.3/3).

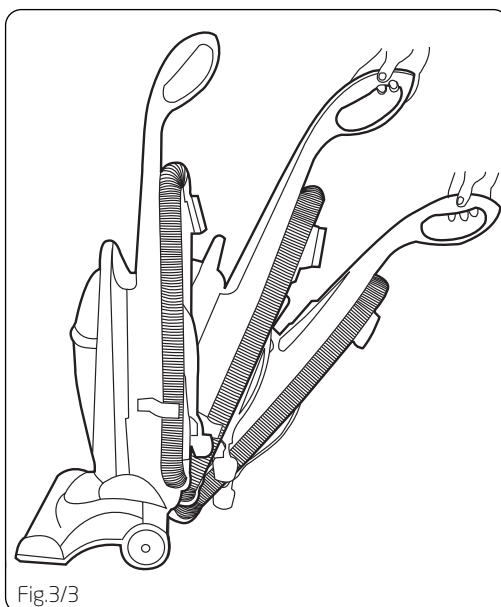

Fig.3/3

To adjust the brush bar for improved cleaning on varying surfaces, turn the carpet height adjuster to the appropriate position. This is found on the base of the unit, in the centre, above the brush bar window.



IMPORTANT: When using the tools and the cleaner is in the upright position, the adjuster must be set to the highest position.



WARNING: To avoid injury keep loose clothing, hair, fingers and all other parts of the body away from the moving parts (i.e. the brush bar) of the cleaner.

The accessories can be used with or without the extension tube. To attach, remove the hose from the machine (see Fig.3/4) and push the desired accessory onto the end.

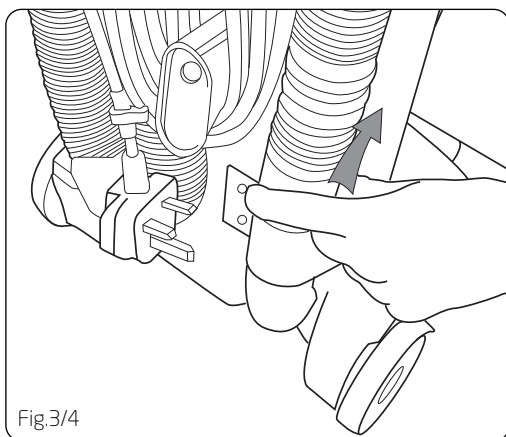

Fig.3/4

The accessories provided are as follows:

Crevice Tool: Use the crevice tool for radiators, crevices, corners, skirting boards and between cushions. **Dusting Brush:** Ideal for window sills, curtains, shelving, and general dust lifting off furniture and fittings around the home.

TurboTool: For pet hairs, stairs and upholstery. The TurboTool should be pulled backwards across the surface that is being cleaned for optimum performance.

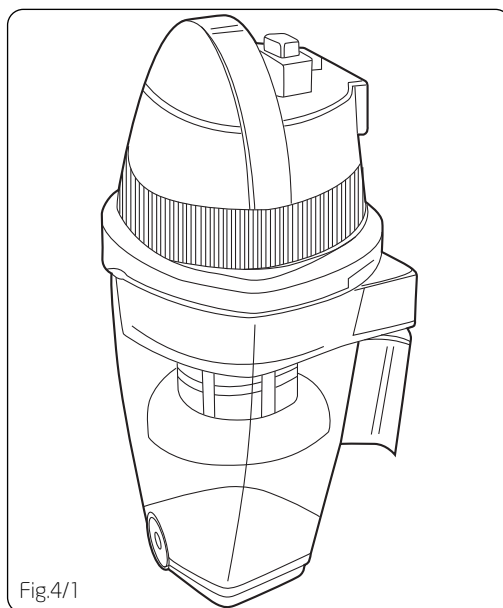

Fig.4/1

Empty all the dirt from the dirt container using the quick release button at the base of the container (see Fig.4/2).

4. Dirt container and filter removal and replacement

IMPORTANT: Always unplug the unit from the electrical outlet before opening the dirt container.

IMPORTANT: Do NOT use the vacuum without the HEPA filter in place. To remove the dirt container, press the dirt container release button and lift away from the vacuum cleaner.

Cleaning the HEPA filter

Remove dirt container lid by grasping the dirt container (see Fig.4/1) and turning anti clockwise.

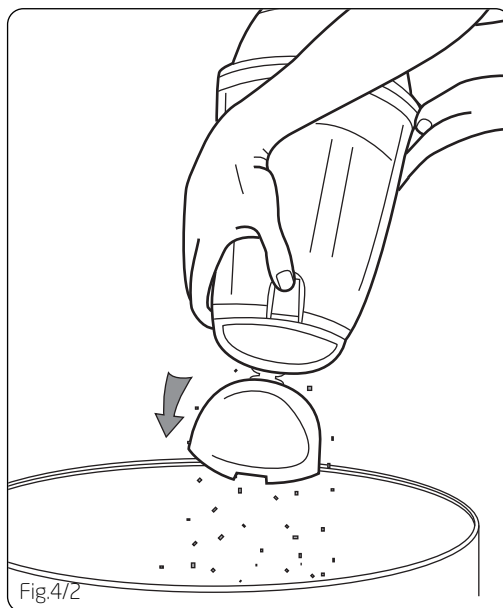

Fig.4/2

Vax V-015

Remove the lid of the dirt container (see Fig.4/3).

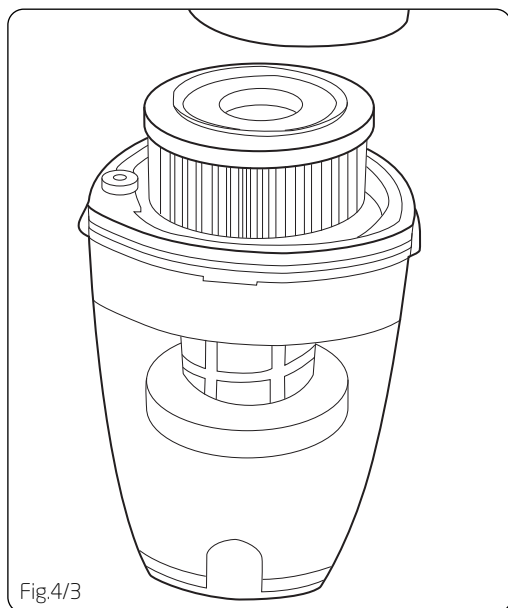

Fig.4/3

Firmly tap clean the HEPA filter (see Fig.4/4) until no more dust is observed falling out.

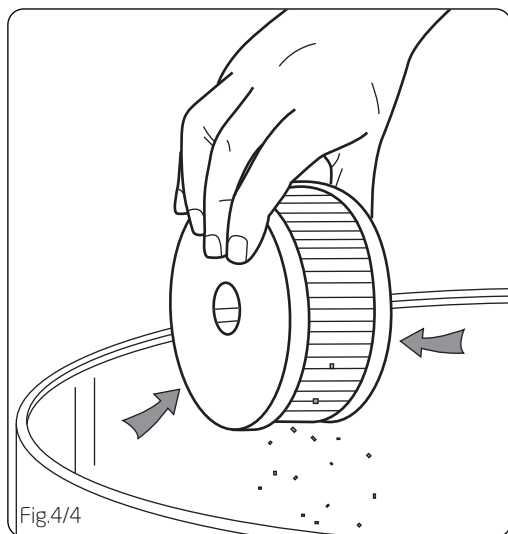

Fig.4/4

! WARNING: Always empty dirt container and clean HEPA filter before each use and during prolonged usage to avoid motor damage.

Cleaning the pre-motor filter

Behind the dirt container, just under the carry handle is a pre-motor filter in the form of a small rectangle shaped piece of foam. This can be cleaned in the same way as the HEPA filter and can also be had washed under the cold tap.

! PLEASE NOTE: Let the filter dry out side the vacuum for 24 hours before replacing / re-using.

The dirt container can be washed in lukewarm water (max 40°C). Do not use strong detergents and ensure dirt container is fully dry before putting back in vacuum cleaner.

5. Maintenance

Cleaning and Changing the Belt

WARNING: Always turn power off before performing any maintenance on the cleaner to reduce chance of an electric shock.

1. Turn vacuum off and unplug from power supply. Press handle release button and recline vacuum to lowest level and lie on a flat surface.
2. Using a Phillips screwdriver, remove the two screws on the topside of the cleaning head (see Fig.5/1) to release the top cover. (see Fig.5/2)

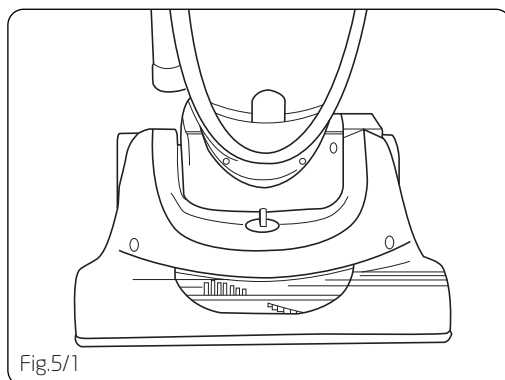

Fig.5/1

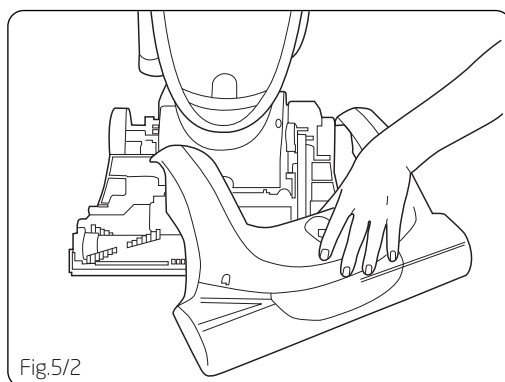

Fig.5/2

3. Lift either side of the brush bar to remove from the cleaning head (see Fig.5/3).

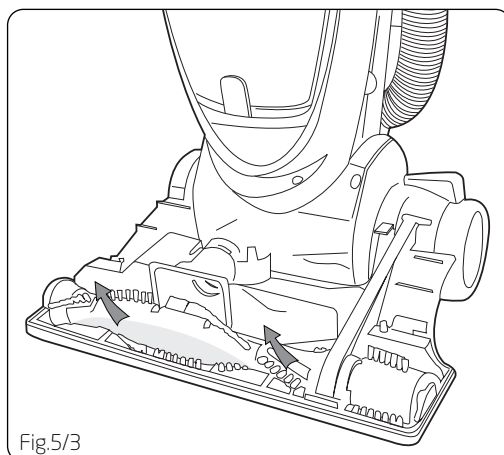

Fig.5/3

4. Remove broken/ worn belt from the motor drive shaft.
5. Remove all belt residue that may exist in the belt area before replacing with a new belt.
6. Loop the new belt first over the motor drive shaft and then over the agitator pulley.
7. Insert the brush bar back into its slots. Press firmly on both sides to make sure either end is completely inserted.
8. Check to make sure that the belt is centred on the agitator pulley and that the brush bar turns.
9. Replace the vacuum head cover by screwing in the 2 screws on the topside.

Removing blockages from the TurboTool

Rotate the locking ring 180°, then turn the TurboTool over. Pivot the lower housing open and then remove any obstructions. To reassemble, ensure the tabs are engaged, pivot the housing closed and reposition the locking ring.

6. Troubleshooting



WARNING: TO REDUCE RISK OF PERSONAL INJURY UNPLUG VACUUM CLEANER BEFORE SERVICING

PROBLEM: Cleaner won't run

Cause: Not properly plugged into electrical outlet.

Solution: Plug cord in firmly.

Cause: No electricity in wall outlet.

Solution: Check fuse or breaker.

Cause: On/off switch not turned on.

Solution: Push on/off switch to on.

Cause: Motor thermostat tripped.

Solution: Reset motor thermostat (see page 3).

Cause: Blown fuse/tripped breaker.

Solution: Reset circuit breaker or replace fuse.

PROBLEM: Cleaner won't pick up

Cause: Full or clogged dirt container.

Solution: Clean dirt container.

Cause: Wrong pile height setting.

Solution: Adjust setting on carpet height adjuster.

Cause: Clogged nozzle.

Solution: Remove obstruction.

Cause: Clogged dirt inlet.

Solution: Remove power head cover and remove obstruction.

Cause: Clogged hose.

Solution: Remove obstruction.

Cause: Broken belt.

Solution: Replace belt.

Cause: Hose not inserted fully.

Solution: Push hose in securely.

Cause: Dirty filters.

Solution: Clean/change filters.

PROBLEM: Accessories won't pick up

Cause: Accessories not attached correctly.

Solution: Refer to section 5 for fitting information.

PROBLEM: Cleaner picks up moveable rugs or pushes too hard

Cause: Wrong pile height setting.

Solution: Adjust setting on carpet height adjuster.

PROBLEM: Brushbar does not turn

Cause: Broken belt.

Solution: Replace belt.

Cause: Belt installed incorrectly.

Solution: Check belt.

PROBLEM: Air flow restricted with attachment use

Cause: Attachment use restricts air flow.

Solution: Check attachment.

Cause: New carpet debris clogging air path.

Solution: Remove obstruction.

7. UK Service & Help

Vax Care 0870 6061248

Monday-Friday. 9.00am to 5.00pm.

An answerphone will be available out of these hours. Any queries or concerns about using your Vax, call the Vax Careline. Calls are charged at the UK national rate.

Please make a note of the model number and serial number of your Vax before calling. There are over 400 approved Vax Service Agents in the UK. For the nearest Vax Service Agent, please call the Vax Careline or visit www.vax.co.uk



8. Technical Specification

| | |
|--------------|--|
| Voltage: | 220 ~ 240V 50Hz |
| Wattage: | 1600W |
| Capacity: | 2.0 litres |
| Filters: | Pleated paper HEPA filter Pre-motor |
| Cord length: | 9.0m |
| Weight: | 7.0kg |

Subject to technical change without notice.

Vax V-015

This page has been left intentionally blank.

This page has been left intentionally blank.



EEC STATEMENT OF COMPLIANCE

Manufacturer/EEC importer: Vax Limited, hereby on our own responsibility, declare that the V-015 is manufactured in compliance with the following Directives:

Safety: 73/23/EEC Low Voltage Directive

EMC: 89/336/EEC Electromagnetic Compatibility Directive



Waste electrical products should not be disposed of with household waste. Please recycle where facilities exist. Check with your Local Authority or retailer for recycling advice.

Vax Ltd., Kingswood Road, Hampton Lovett, Droitwich, Worcestershire, WR9 0QH, UK
email: info@vax.co.uk - website: www.vax.co.uk